

# SAMSUNG



BN68-15687D-01

## About the Samsung SolarCell Remote (Samsung Smart Remote)

**Solar Cell**  
Expose to light when the remote is not in use. This will extend the remote's operating time.

**USB port (C-type) for charging**  
Used for quick charging. The LED on the front will light when charging. When the battery is fully charged, the LED will turn off.

- The USB Cable is not provided.

- Warning:** Fire or explosion may occur, resulting in damage to the remote control or personal injury.
- Do not apply shock to the remote control.
  - Be careful not to let foreign substances such as metal, liquid, or dust come in contact with the charging terminal of the remote control.
  - When the remote control is damaged or you smell smoke or burning fumes, immediately stop operation and then repair it at the Samsung service centre.
  - Do not arbitrarily disassemble the remote control.
  - Be careful not to let infants or pets suck or bite the remote control. Fire or explosion may occur, resulting in damage to the remote control or personal injury.

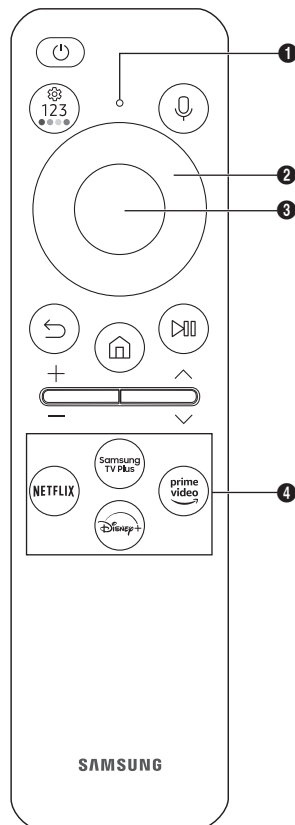

Button	Description
(Power)	Press to turn the TV on or off. For The Frame model, When watching TV, press to switch to <b>Art</b> mode. In <b>Art</b> mode, press to switch to the <b>Media Home</b> . Press and hold to turn off the TV completely.
MIC / LED	Used as MIC when using voice recognition with the remote control. When charging the remote control via the USB port, the LED is lit if charging is in progress. When charging is complete, the LED is turned off. <ul style="list-style-type: none"> <li>Do not impact the MIC hole or use a sharp object to poke into the hole.</li> </ul>
(Voice Assistant)	Runs Voice Assistant. Press and hold the button, say a command, and then release the button to run Voice Assistant. <ul style="list-style-type: none"> <li>The supported Voice Assistant's languages and features may differ by geographical area.</li> </ul>
(Settings / Number / Colour button)	Each time you press this button, Settings menu / virtual numeric pad / Option pad with Colour buttons are displayed alternately. <ul style="list-style-type: none"> <li>Use this button to access additional options that are specific to the feature in use.</li> <li>Press to bring up the virtual numeric pad on the screen. Use the numeric keypad to enter numeric values. Select numbers and then select <b>Done</b> or <b>Enter Number</b> to enter a numeric value. Use to change the channel, enter a PIN, enter a ZIP code, etc.</li> <li>When pressed for 1 second or more, the <b>Shortcuts</b> menu screen appears.</li> </ul>
Directional button (up, down, left, right)	Moves the focus and changes the values seen on the TV's menu.
Select	Selects or runs a focused item. When pressed while you are watching a broadcast programme, detailed programme information appears.
(Return)	Press to return to the previous menu. When pressed for 1 second or more, the running function is terminated. When pressed while you are watching a programme, the previous channel appears.
(Smart Hub)	Press to switch to the Home Screen.
(Play/pause)	When pressed, the playback controls appear. Using these controls, you can control the media content that is playing. To use Game Bar, press and hold the button in <b>Game Mode</b> . <ul style="list-style-type: none"> <li>Game Bar may not be supported depending on the model or geographical area.</li> </ul>
+ / - (Volume)	Move the button up or down to adjust the volume. To mute the sound, press the button. When pressed for 2 seconds or more, the <b>Accessibility Shortcuts</b> appears.
^ / v (Channel)	Move the button up or down to change the channel. To see the <b>Guide</b> screen, press the button. <ul style="list-style-type: none"> <li>When pressed for 1 second or more, the <b>Channel List</b> screen appears.</li> </ul>
4 Launch app button	Press each button to run its function. <ul style="list-style-type: none"> <li>Available apps may differ depending on the geographical area or contents provider.</li> </ul>
(Pairing)	If the Samsung Smart Remote does not pair to the TV automatically, point it at the front of the TV, and then press and hold the  and  buttons simultaneously for 3 seconds or more.

- Use the Samsung Smart Remote less than 6 m from the TV. The usable distance may vary with the wireless environmental conditions.
- The images, buttons, and functions of the Samsung Smart Remote may differ with the model or geographical area.
- The Universal Remote function operates normally only when you use the Samsung Smart Remote that comes with the TV.
- It is recommended to use an original Samsung charger. Otherwise, it may cause performance degradation or failure of the product. In this case, the warranty service is not applicable.
- When the remote control does not work due to low battery, charge it by using the USB-C type port.

### UK Declaration of Conformity

#### Product Details

Product : Smart Control  
Model(s) : VG-TM2360E  
Variant Model(s) : VG-TM2360F, VG-TM2360G

#### Declaration and applicable standards

We hereby declare under our sole responsibility that the product above is in compliance with the essential requirements of the Radio Equipment Regulations 2017 by application of:

<b>EMC</b>	<b>Safety</b>
EN 301 489-1 V2.2.3	EN IEC 62368-1:2020+A11:2020
EN 301 489-17 V3.2.4	EN IEC 62368-3:2020
<b>Radio</b>	EN 62311:2008
EN 300 328 V2.2.2	

and the Restriction of the Use of Certain Hazardous Substances in Electrical and Electronic Equipment Regulations 2012 by application of EN IEC 63000:2018.

**Signed for and on behalf of : Samsung**  
Samsung Euro QA Lab, Saxony Way, Yateley, GU46 6GG, UK \*  
2022-11-04 (Place and date of signature)

Stephen Colclough – Director Regulatory Affairs  
(Name and signature of authorized person)  
\* This is not the address of Samsung Service Centre. Please see the address or the phone number of Samsung Service Centre in the warranty card or contact the retailer where you purchased your product.

# SAMSUNG

## About the Buttons on the Standard Remote Control

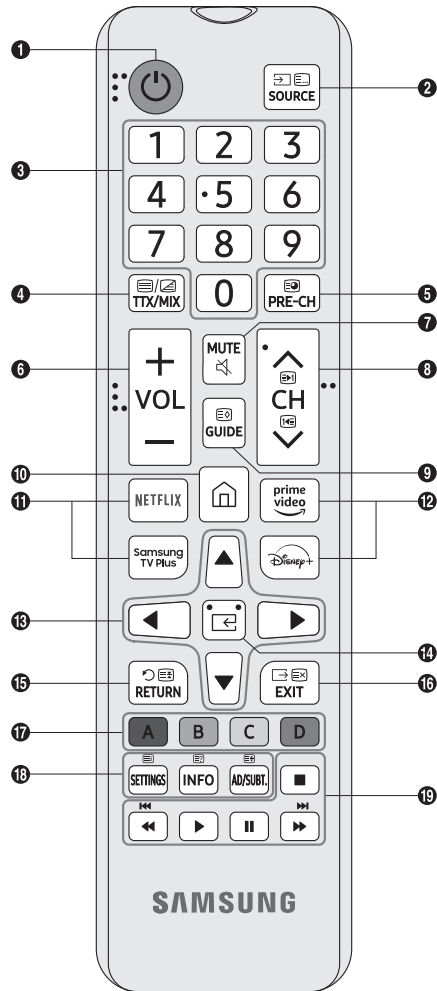

Number	Description
1	⏻ (Power) Turns the TV on and off.
2	Displays and selects available video sources.
3	Gives direct access to channels.
4	Alternately selects Teletext mode, Full TTX / Double TTX / Mix / Live TV.
5	Returns to the previous channel.
6	Adjusts the volume.
7	Turns the sound on/off.
8	Changes the current channel.
9	Displays the Guide screen.
10	Press to switch to the Media Home.
11, 12	Press each button to run its function. • Available apps may differ depending on the geographical area or contents provider.
13	Moves the cursor, selects the on-screen menu items, and changes the values seen on the TV's menu.
14	⏏ (Select) Selects or runs a focused item.
15	Returns to the previous menu or channel.
16	Exits the menu.
17	Use these buttons according to the directions on the TV screen.
18	<b>SETTINGS</b> Displays the main on-screen menu. <b>INFO</b> Displays information about the current programme or content. <b>AD/SUBT.</b> Displays the Accessibility Shortcuts.
19	Use these buttons with specific features. Use these buttons according to the directions on the TV screen.

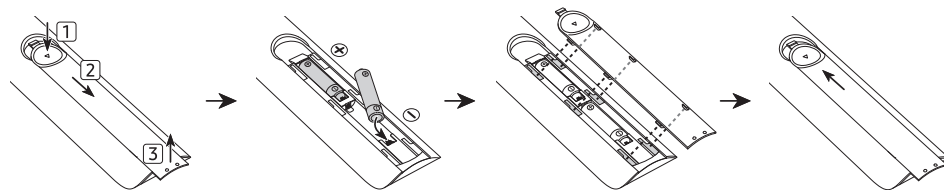

- The images, buttons, and functions of the remote control may differ depending on the model.
- This remote control has Braille points on the Power, Channel, Volume, and Select buttons and can be used by visually impaired persons.
- If you use the remote control that comes with your TV to control another TV, some functions may not operate normally.