

Pro:Centric® Enhanced Hospitality UHD TV

The UV560H Series features UHD resolution that creates vivid details and a flawless picture. The UV560H features ProCentric® and Pro:Idiom® technologies that allows for easy management, configuration and updates to guest room TVs via a centralized management system.



UV560H

- HTML5 Platform – hosts 3rd Party HTML5 programs
- Pro:Centric Direct Application Support
- RF Tuning only (no IP tuning)
- Supports RF or IP Pro:Centric data channel
- 4K ULTRA HD Resolution
- Integrated Pro:Idiom DRM
- Commercial Grade Stand (Except 65UV560H)

Screen Sizes

43" class (42.5" diagonal), 49" class (48.7" diagonal), 55" class (54.8" diagonal), 65" class (64.6" diagonal)

Key Features

Pro:Idiom®

GLOBAL LEADING DIGITAL RIGHTS MANAGEMENT SOLUTION

Pro:Idiom unlocks access to premium content to help ensure rapid and broad deployment of HDTV and other high value digital content.

Pro:Idiom has been designed specifically for users of premium HDTV content from cables satellite, or video on demand (VOD) services, and is intended to lower costs and reduce maintenance. this leading DRM system is embraced for its security solutions helping to prevent illegal copying of copyrighted content.

Pro:Centric® Application

LG's Pro:Centric Application enhances guests' experience of their in-room hotel TVs. Guests can locate and enjoy available television programming, check on the daily weather and review hotel amenities—all from the comfort of their room using their LG HD TV. With remote management, individual room visits are no longer required for TV software and TV configuration updates, which can help save time and potential labor costs. Updates may be loaded on the Pro:Centric server using the Pro:Centric Admin Client. The Pro:Centric Admin Client also enables users to remotely update the Pro:Centric Application features.

Pro:Centric Direct Ready

Simply create your own user interface designs and remotely manage TVs on the properties' distribution network with Pro:Centric Direct, LG's new HTML-based content management software. Pro:Centric Direct offers a comprehensive HTML UI (User Interface) Editor, along with customizable drag and drop widgets and multiple theme templates to enable system integrators to create a unique guest user experience and express the hotel's brand identity and individuality. Hotels can use the system to promote branding and provide useful information for guests, such as available amenities, weather and flight information. The interactive features, including a free-of-charge Electronic Program Guide (EPG) and support for embedded smart applications, will impress guests by elevating their in-room television entertainment experience. Plus, for hoteliers, not only does it offer efficient content production and management, it also maximizes advertisement or promotion effectiveness.

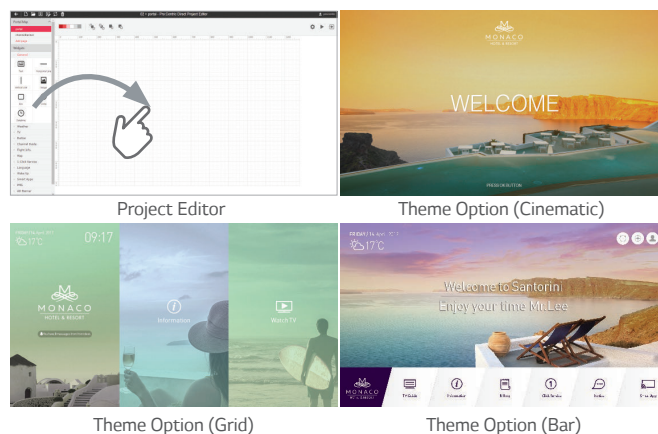

Pro:Centric® Enhanced Hospitality UHD TV

Pro:Centric acts as a digital concierge. Guests are presented with a branded user interface on the television and can view electronic billboard and map pages that present information on hotel amenities, such as restaurants, bars, fitness and business centers. Guests may also use the interactive Electronic Program Guide (EPG) to select their favorite sitcom or find premium movie channels.

4K RESOLUTION

4K ULTRA HD is the future of digital picture, possessing four times higher resolution than that of full HD. Stunning 8.3 million pixels gives a flawless picture quality and incredibly vivid detail.



4K UPSCALER

Enjoy Full HD content in 4K ULTRA HD quality. The 4K Upscaler automatically upgrades Full HD content to ULTRA HD through the six steps of the upscaling processes.



4K IPS WIDE VIEWING ANGLE

One of the secrets behind outstanding viewing experience with LG TVs is the specially designed TV panel. 4K IPS delivers true colour from any angle with 4 times the resolution of Full HD. With 4K IPS, every seat is the best for watching content in your space.



FREE INTERACTIVE EPG SERVICE FOR Pro:Centric TVs

PLAN HIGHLIGHTS

If your property has purchased or plans to purchase LG's Pro:Centric TVs, you may qualify for a free EPG that allows guests to easily navigate TV channels and programs, just like they do at home.

Participating properties must purchase and install a Pro:Centric server and supply an internet connection for daily program updates. Properties must also contract with an LG authorized partner to install and program the server to match your Free-To-Guest (FTG) Channel Map.

Free program guide service runs until December 2017, replacing the previous programming fee of \$1.50 per room per month.

Contact your LG sales representative or visit: www.LG.com/us/commercial/display-discover/epg

LG's FTG COST EFFECTIVE SOLUTION

When using LG televisions in FTG hotel installations, the Pro:Centric server (PCS200S) supports remote management of TV settings. With remote updates, including FTG Channel Map and FTG Installer Menu settings updates, management, individual room visits are no longer required for TV configuration thereby saving labor costs.

Hotel Costs For FTG Channel Management

	Estimated Labor Costs	MSRP	Total	Potential savings over room visit
LG Pro:Centric TV with Pro:Centric Server		\$2,499 (PCS200S)	\$2,499	\$17,501
Manual Room Updates	\$20(est.) x 2 times per year (to update channels) x 100 rooms x 5 years		\$20,000	

MSRP subject to change. Installation not included.

HEAD END SYSTEM

Remote management functions are supported via the Pro:Centric server. The Pro:Centric Application software can be remotely added at a later date to deliver the benefits of LG's Pro:Centric Application features. (Weather, EPG, Billboards, etc)



Hospitality Features



Commercial Grade Stand (Except 65UV560H)

Expand the range of viewing with the commercial grade stand that swivels up to 180 degrees, allowing guests to watch TV from virtually any angle in the room. For added security, the stand can be secured to furniture.



Welcome Screen

Have a warm greeting message with your hotel name and its logo on the TV when it is turned on. The welcome screen provides an inviting, personalized experience for your guests.



Remote Diagnostics

The TV stores diagnostic data, which can be saved to a USB memory device, thus enabling service engineers to analyze the data and identify technical issues quickly and easily.



External Speaker Out Compatibility (Speaker Sold Separately)

Enhance the in-room guest experience by adding an external speaker (sold separately) for improved audio performance.



USB Cloning

Clone your commercial TVs with speed and ease. The USB Cloning feature allows you to simply copy and transfer TV settings from a designated master TV to all target TVs using a USB memory device.

Pro:Centric® Enhanced Hospitality UHD TV

Dimensions (With Stand : W x H x D / Weight)

43"

38.3" x 24.6" x 11.9" /
27.4lb
*Swivel

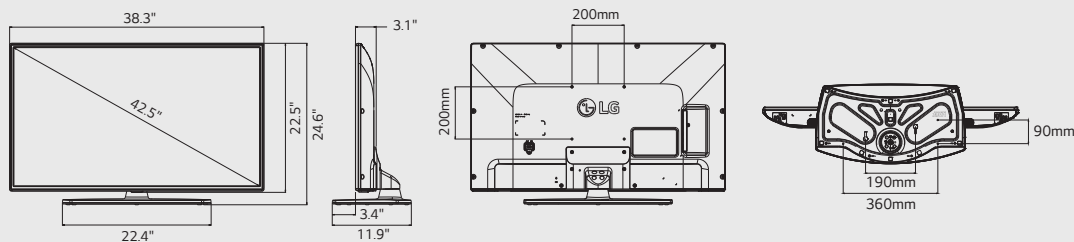

49"

43.6" x 27.6" x 11.9" /
32.1lb
*Swivel

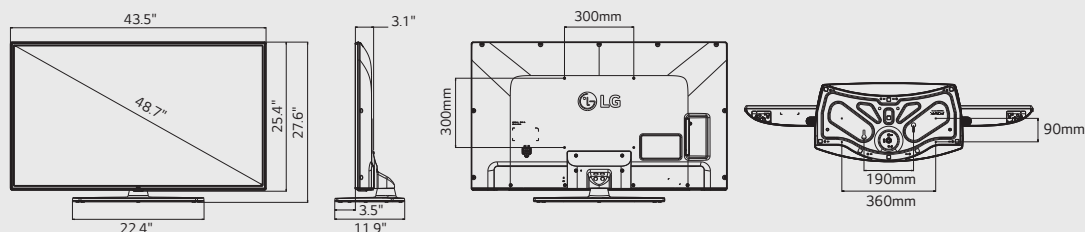

55"

48.7" x 30.5" x 11.9" /
35.3lb
*Swivel

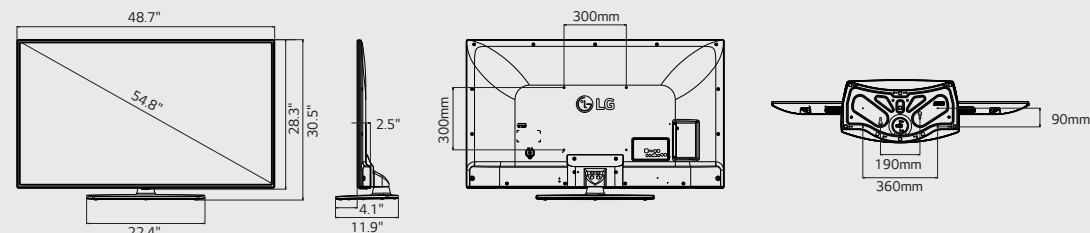

65"

57.3" x 35.8" x 10.7" /
58.2lb

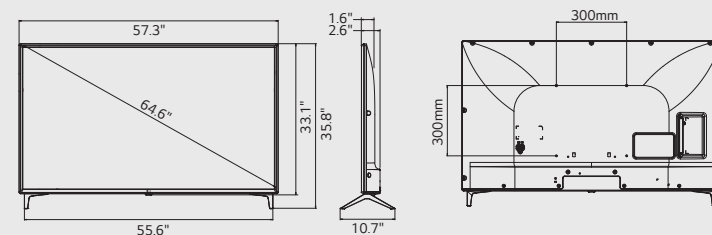

Jack Panels (Rear/Side)

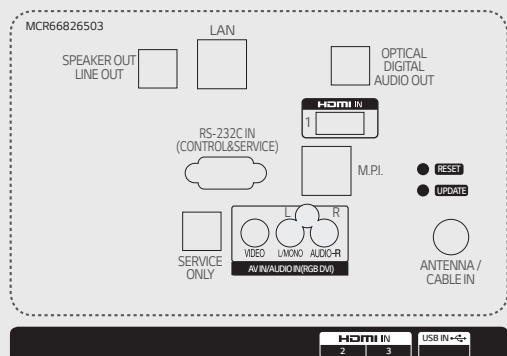

Anti-Theft System (Except 65UV560H)



Kensington Lock Slot

- The UV560H series feature a Kensington lock slot, so hotels can securely lock the TV. (Lock sold separately)



Reinforced Metal Stand

- Full metal reinforced stand to improve sturdiness, durability and safety.
- Provides ($\pm 20^\circ$) swivel out of the box.
- Provides ($\pm 20/45/90^\circ$) swivel when used with Lock Down plate.



Lock Down Plate with Credenza Hole

- Lock the TV firmly to the credenza for added security and help deter theft. (Mounting plate, security bolts, nuts and screws are included.)

Specifications

UV560H

		43	49	55	65
DISPLAY	Diagonal Size	42.5"	48.7"	54.8"	64.6"
	Type	Direct LED		Edge LED	
	Resolution	3,840 x 2,160 (4K UHD)			
	Dynamic contrast ratio	1,000,000:1			
	Static (panel) contrast ratio	1,200:1			
	Viewing Angle Degree	178° / 178°			
	Response Time (G to G)	8			
	Frame Rate	T120			
BROADCASTING SYSTEM	Analog	NTSC			
	Digital	ATSC / VSB / Clear QAM			
	MPEG-2/MPEG-4 H.264 DECODING	•			
VIDEO	XD Engine	•			
	Real Cinema 24p (3:3 Pull down)	•			
	Picture Mode	• 9 modes (Vivid, Standard, APS (Eco), Cinema, Sports, Game, HDR Effect, Expert (Bright Room), Expert (Dark Room))			
	Aspect Ratio	• 6 modes (16:9, Original, 4:3, Vertical Zoom, All-Direction Zoom, Just Scan)			
AUDIO	HDR	HDR10			
	Audio Output / Speaker System	10W + 10W / 2.0 ch			
	Sound Mode	• 6 modes (Standard, Cinema, Clear Voice III, Sports, Music, Game)			
	Clear Voice	•			
GENERAL FEATURES	Optical Sound Sync	•			
	Type	Single Tuner			
	Pro:Centric Application	PCA 3.7.5 / PCD V2.0			
	Server	PCS200S/PCS400R			
	RF	1 Tuner			
	HCAP (SDK)	GEM / Flash / HTML5 (RF Only)			
	Digital Rights Management	ProIdiom			
	Management	Wake on RF, Remote Diagnostics, SI Compatibility (MPI / RS-232C Protocol), IR Out (MPI Jack / RS-232C), Multi IR Code			
	Installation	EZ-Manager Wizard (for Initial Configuration), USB Cloning			
	Interactivity	HTNG / HDMI-CEC			
	USB	Moving Picture Playback (.asf, .wmv, .avi, .mp4, .m4v, .mov, .3gp, .3g2, .mkv, .mpg, .mpeg, .dat, etc.), Picture (.jpeg, .jpg, .jpe, BMP, PNG), Audio Codec (.mp3, .wav, OGG, WMA, .flac)			
Advanced Setting Option	Auto Off / Sleep Timer, Smart Energy Saving, Motion Eye Care				
Anti-theft System	Kensington Lock, Credenza / Security Screw Hole, Lock Down Plate (except 65")			-	
HOSPITALITY FEATURES	Installer Menu, Welcome Screen (Splash Image), Logical Channel Map (LCM), External Speaker Out, Instant On, RJP Compatibility				
INTERFACE	Side	HDMI (2), USB 2.0			
	Rear	RF In, AV In, Digital Optical Audio Out, HDMI Input, RS-232C (Control & Service), RJ45, External Speaker Out, MPI Port, Debug			
DESIGN	Stand	(20/45/90°) Swivel (except 65")			-
ACCESSORIES	Power Cable (5.9 ft., Angle Type), Owner's Manual / Easy Setup Guide				
DIMENSIONS	Vesa (mm)	200 x 200		300 x 300	
	W x H x D / weight (without stand)	38.3" x 22.5" x 2.8" / 20.3lb	43.6" x 25.4" x 2.8" / 24.9lb	48.7" x 28.3" x 1.6" / 35.3lb	57.3" x 33.1" x 1.6" / 57.3lb
	W x H x D / weight (with stand)	38.3" x 24.6" x 11.9" / 27.4lb	43.6" x 27.6" x 11.9" / 32.1lb	48.7" x 30.5" x 11.9" / 43.0lb	57.3" x 35.8" x 10.7" / 58.2lb
	W x H x D / weight (Carton)	45.2" x 26.0" x 6.9" / 32.2lb	51.0" x 30.3" x 6.7" / 39.2lb	53.5" x 33.9" x 7.5" / 53.4lb	63.0" x 38.2" x 6.9" / 72.3lb
POWER	Voltage, Hz	100-240V, 50 / 60 Hz			
	Typical (Watts)	58.0	50.8	44.8	40.9
	Stand-by (Watts)	< 0.5			
STANDARD APPROVAL	Safety	UL			
	Environment	FCC			
	Etc.	RoHS, UL, NOM, ENERGY STAR® Qualified			
UPC	719192616325	719192616349	719192616363	719192616387	



Commercial Grade Stand

The estimated annual energy cost determined in accordance with 16 CFR Part 305.5 for model 43UV560H, 49UV560H, 55UV560H, and 65UV560H are \$11, \$12, \$12, and \$14 respectively.

"Your energy cost depends on your utility rates and use. The estimated cost is based on 12 cents per kWh and 5 hours of use per day. For more information, visit www.ftc.gov/energy/"

FTC Television labeling rule (18 CFR Part 305, as added by 76 Fed. Reg. 1038 (Jan 6, 2011)).

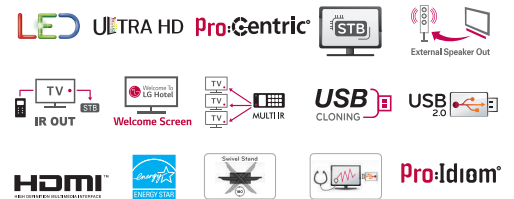

Download LG Commercial Display Mobile App



Apple App Store



Google Play Store

Learn more www.LG.com/us/commercial

YouTube youtube.com/c/LGCommercialDisplay

All screen images are simulated. Dimension and weights are approximate. Design, features and specifications subject to change without notice.

© Copyright 2017 LG Electronics Inc. All Rights Reserved. Pro:Centric, the "LG" logo, XD Engine are registered trademarks or trademarks of LG Electronics Inc. ProIdiom is a registered trademark of Zenith Electronics LLC. All other trademarks or registered trademarks are the property of their respective owners. | SPEC_UV560H_101707_PR

